

MEMOR™ FAMILY

QUICK START GUIDE



SMART DOCKING STATION
MODEL: SGVDKS

Warranty Terms and Conditions

Refer to the Memor device User's Manual, downloadable from our website.

www.datalogic.com



822004731 (Rev. B) November 2024

FAST THE SMART DOCKING STATION TO A SURFACE

To securely fasten the Docking Station to tables, desks and other surfaces, and to prevent the dock from moving when you remove the device, use the four velcro dual lock feet provided with the matching dual lock adhesive pads.

1. Stick each dual lock foot together with its dual lock adhesive pad.

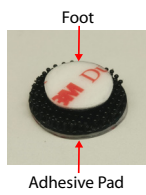

2. Peel off the protective liner from the back of the adhesive pads and place them on the bottom of the smart docking station.



3. Peel off the protective liner from the back of the feet, place the smart docking station on a pre-cleaned surface and press firmly into place.



Datalogic S.r.l.

Via San Vitalino 13
40012 Calderara di Reno (BO)
Italy
Tel. +39 051 3147011
Fax +39 051 3147205

©2024 Datalogic S.p.A. and/or its affiliates

All rights reserved. Without limiting the rights under copyright, no part of this documentation may be reproduced, stored in or introduced into a retrieval system, or transmitted in any form or by any means, or for any purpose, without the express written permission of Datalogic S.p.A. and/or its affiliates.

Owners of Datalogic products are hereby granted a non-exclusive, revocable license to reproduce and transmit this documentation for the purchaser's own internal business purposes. Purchaser shall not remove or alter any proprietary notices, including copyright notices, contained in this documentation and shall ensure that all notices appear on any reproductions of the documentation.

Electronic versions of this document may be downloaded from the Datalogic website (www.datalogic.com). If you visit our website and would like to make comments or suggestions about this or other Datalogic publications, please let us know via the "Contact" page.

Disclaimer

Datalogic has taken reasonable measures to provide information in this manual that is complete and accurate, however, Datalogic shall not be liable for technical or editorial errors or omissions contained herein, nor for incidental or consequential damages resulting from the use of this material. Datalogic reserves the right to change any specification at any time without prior notice.

Trademarks

Datalogic and the Datalogic logo are registered trademarks of Datalogic S.p.A. in many countries, including the U.S.A. and the E.U.

Memor is a trademark of Datalogic S.p.A. and/or its affiliates. All other brand and product names may be trademarks of their respective owners.

Support Through the Website

Datalogic provides several services as well as technical support through its website.

Log on to www.datalogic.com.

For quick access, from the home page click on the search icon , and type in the name of the product you're looking for. This allows you access to download Data Sheets, Manuals, Software & Utilities, and Drawings.

Hover over the Support & Service menu for access to Services and Technical Support.

OUT OF THE BOX

The Memor Smart Docking Station package contains:

- Docking Station
- Dual Lock Feet (x4)
- Dual Lock Adhesive Pads (x4)
- Quick Start Guide.

Remove all the components from their packaging; check their integrity and compare them with all the packing documents.



CAUTION: Keep the original packaging for use when sending products to the technical assistance center. Damage caused by improper packaging is not covered under the warranty.

GENERAL VIEW

Front View

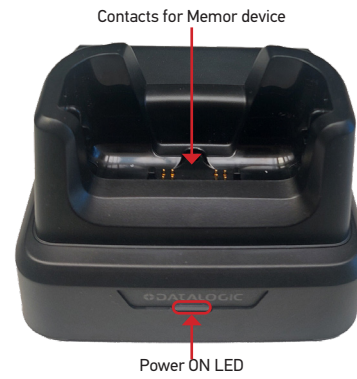

Back View

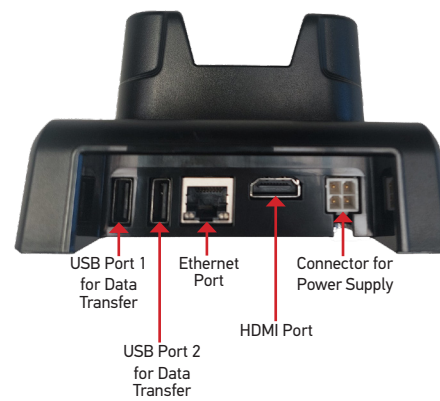

Side View



MEMOR ADAPTERS

Scan/click the QR code to check the availability and compatibility of Memor accessories and adapters:



POWER THE SMART DOCKING STATION



CAUTION: Use only the Datalogic power supply 94ACC0380 to power the Smart Docking Station.

Press the locking clip and pull the plug to remove the power supply cable.

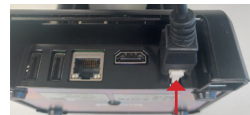

CHARGE THE MEMOR DEVICE

Install the protective boot on the device, or insert the adapter into the smart docking station as shown below.



Insert the device into the smart docking station with the screen facing front and the head facing up.

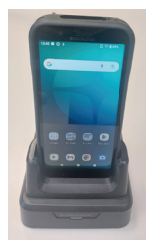

Memor Device with Protective Boot Memor Device without Protective Boot

To remove the device from the smart docking station, pull it upwards while holding the smart docking station firmly down.

CONNECTIONS

The smart docking station connecting ports enable your device to be used as a workstation computer when connected to a keyboard, mouse, HDMI monitor, printer, external hard disk, flash drive, payment terminal or any other peripheral.

In the minimal configuration you can connect mouse, keyboard and monitor using the ports on the rear side to hide the cables.

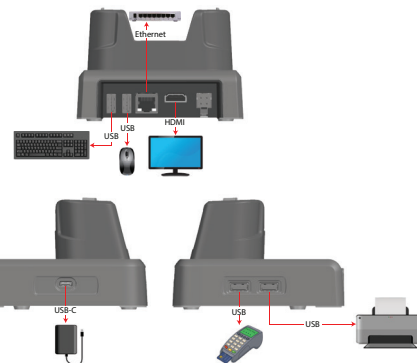

USB Connection

1. Connect the smart docking station to the USB device by means of a standard USB to USB cable.
2. Turn on the Memor device.
3. Insert the Memor device into the smart docking station.

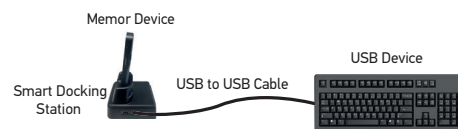

USB-C Connection

1. Connect the smart docking station to the USB device by means of a standard USB to USB Type-C cable.
2. Turn on the Memor device.
3. Insert the Memor device into the smart docking station.

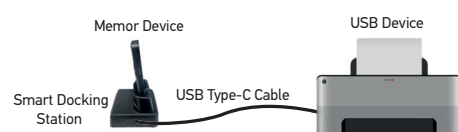

Ethernet Connection

1. Plug a CAT-5 ethernet cable into the ethernet port on the back of the smart docking station.
2. Plug the ethernet cable into the ethernet hub or a port on the host device.
3. Turn on the Memor device.
4. Insert the Memor device into the smart docking station.



HDMI Connection

1. Turn on the HDMI device.
2. Plug an HDMI cable into the HDMI port on the back of the smart docking station.
3. Plug the HDMI cable into the HDMI port on the HDMI device.
4. Turn on the Memor device.
5. Insert the Memor device into the smart docking station.

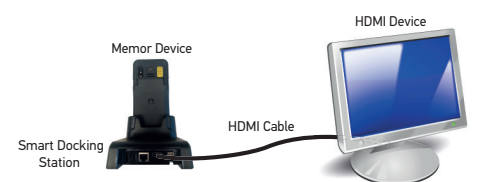

DESKTOP MODE SETTINGS

Desktop Mode preference can be changed from the Memor device, under **Settings > Datalogic Settings > Desktop Mode > Desktop Mode Policy**.

- Mirror screen: copy the device screen. This may produce black bars on the sides to accommodate different orientations.
- External screen (Default): use the external screen.
- Dual screens: operate each screen separately.

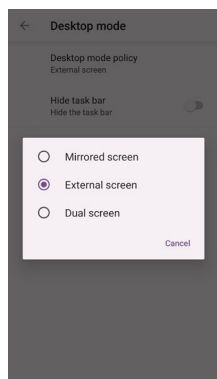
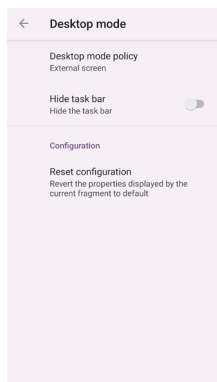

LED INDICATORS

LED Behavior	Operation Status
Power ON	
Solid blue	Dock is powered

TECHNICAL SPECIFICATIONS

Mechanical Features	
Dimensions	120 x 125 x 79.5 mm / 4.72 x 4.92 x 3.13 in
Weight	366 g / 12.91 oz
Electrical Features	
Power supply ¹	Max 12VDC
Consumption	Max 1.5 A with device inserted
Indicators	Power on LED (blue)
Communication Features	
Interfaces	USB, USB Type-C, Ethernet, HDMI
Environmental Features	
Operating Temperature	0° to 50°C
Storage Temperature ²	-30°C to 70°C
Humidity	95% non condensing
Electrostatic discharge EN 61000-4-2	4 KV contact / 8 KV air

GENERAL SAFETY RULES



CAUTION:

- Use only the components and accessories supplied by the manufacturer for the specific Memor device being used.
- Do not attempt to disassemble the Memor Smart Docking Station, as it does not contain parts that can be repaired by the user. Any tampering will invalidate the warranty.
- Do not submerge the Memor Smart Docking Station in liquid products.
- For further information or support, refer to the Datalogic web site: www.datalogic.com.

WEEE STATEMENT



Waste Electrical and Electronic Equipment (WEEE) Statement

English

For information about the disposal of Waste Electrical and Electronic Equipment (WEEE), please refer to the website at www.datalogic.com.

Italian

Per informazioni sullo smaltimento delle apparecchiature elettriche ed elettroniche consultare il sito Web www.datalogic.com.

French

Pour toute information relative à l'élimination des déchets électroniques (WEEE), veuillez consulter le site internet www.datalogic.com.

German

Informationen zur Entsorgung von Elektro- und Elektronik- Altgeräten (WEEE) erhalten Sie auf der Webseite www.datalogic.com.

Spanish

Si desea información acerca de los procedimientos para el desecho de los residuos del equipo eléctrico y electrónico (WEEE), visite la página Web www.datalogic.com.

Portuguese

Para informações sobre a disposição de Sucatagem de Equipamentos Elétricos e Eletrônicos (WEEE -Waste Electrical and Electronic Equipment), consultar o site web www.datalogic.com.

Chinese

有关处理废弃电气电子设备 (WEEE) 的信息, 请参考 Datalogic 公司的网站 www.datalogic.com.

Japanese

廃電気電子機器(WEEE)の処理についての関連事項はDatalogicのサイト www.datalogic.com をご参照下さい。

¹ Use only DL approved power adapters.
² The Memor device should be charged at an ambient temperature between 0 - 40° C to achieve the maximum charging rate. Never charge the main device or spare battery in a closed space where excessive heat can build up.
Close to the limits of the working temperature, some display and/or battery performance degradation may occur.